

Haier

Refrigerator / Freezer Operation Manual

HB21TNNB
HTD647AS
HTD647SS
HTD647AW
HTD647ASS
HTD647RSS

Congratulations on your purchase of this Haier Appliance!

In order to gain the maximum benefit and understand the features and benefits of this appliance, please ensure you read this User Manual in full.

Haier reserves the right to update and improve the features of this product, so some features and designs may differ slightly from your model.

If you have any queries relating to the operation of this appliance, please contact your local Haier retailer or Customer Care Centre.

The appliance must be positioned so that the plug is accessible.

If the supply cord is damaged, it must be replaced by the manufacturer, its service agent or similarly qualified persons in order to avoid a hazard.

Warning: Keep ventilation openings, in the appliance enclosure or in the built-in structure, clear of obstruction.

Warning: Do not damage the refrigerant circuit.

Warning: Do not use electrical appliances inside the food storage compartments of the appliance, unless they are of the type recommended by the manufacturer.

The appliance is not to be used by children or persons with reduced physical, sensory or mental capabilities, or lack of experience and knowledge, unless they have been given supervision or instruction.

Do not damage the refrigerant circuit.

Do not use electrical appliances inside the food storage compartments of the appliance, unless they are of the type recommended by the manufacturer.



Meaning of crossed-out wheeled dustbin:

Do not dispose of electrical appliances as unsorted municipal waste, use separate collection facilities. Contact your local government for information regarding the collection systems available.

If electrical appliances are disposed of in landfills or dumps, hazardous substances can leak into the groundwater and get into the food chain, damaging your health and well-being.

When replacing old appliances with new ones, the retailer is legally obligated to take back your old appliance for disposals at least free of charge.



HTD647RSS MODEL:R600a REFRIGERANT

This appliance may contain a small quantity of environmentally friendly, but flammable, non-synthetic R600a refrigerant: Upon opening and installing your product, check that the tubing of the refrigerant circuit is not damaged during transportation. Leaking refrigerant may cause eye injuries or ignite. The room for installing appliance must be at least 1m per 8g of refrigerant. The amount of refrigerant in the appliance can be found on the rating plate the back of the unit. Keep ventilation openings in the appliance enclosure or in the built-in structure clear of obstruction. Do not damage the refrigeration circuit. If you are unsure of the refrigerant type check the rating plate on the back of the unit.

Table of Contents

Before Use

Features	1
Names of Parts	2
Safety Precautions	3-5
Location	6
Removing & Replacing Door	7-8
Preparation	9-12
Initial Use	13
Functions	14-15

Instructions for Refrigerator Compartment

About Refrigerator Compartment.....	16-17
Storing Food in Refrigerator Compartment.....	18
Useful Tips.....	19
About Freezer Compartment.....	19-20
Storing Food in Freezer Compartment.....	21

Defrosting • Cleaning • Vacation

Cleaning	22
Vacation	23-24

Troubleshooting • After-sale Services

Troubleshooting Tips	25-26
After-sale Services.....	27

Technical Data • Circuit Diagram • Packing List

About HTD647RSS Refrigerator And Freezer Compartment.....	28
Packing List	29

- Please read this User Manual carefully before use.
- Please keep this User Manual in a safe place.
- Your refrigerator could be slightly different from that illustrated herein with respect to appearance or colour.

Features

① LCD Display & Temperature Controls

Displays refrigerator and freezer temperatures, and allows setting of temperatures individually in both compartments. Access other functions and view current time and ambient room temperature on the easy to read LCD display.

② Refrigerator Chilled Compartment

Store dairy and delicatessen items in the easy to access drawer, suitable for foods that require storage from -2 degrees to +3 degrees Celcius.

③ Adjustable Safety Glass Shelves

Store dairy and delicatessen items in the easy to access drawer, suitable for foods that require storage from -2 degrees to +3 degrees Celcius.

④ AI Temperature Control

Automatically monitors and adjusts the temperature in the refrigerator according to outside (ambient) temperature, and current temperature in the refrigerator itself to ensure the optimum storage environment for your food.

⑤ Frost Free

Automatic defrost cycle ensures that no ice or excess moisture is created in both compartments, and maintains a stable temperature of fridge and freezer.

⑥ Air Curtain/Cyclic Cooling

The use of fan forced cooling to ensure even temperature control, and create an air curtain effect to retain cool air in the refrigerator cabinet when the door is opened

⑦ R600 Refrigerant

More environmentally friendly cooling through the use of R600A refrigerant, combined with efficient condenser, fan motor and compressor design and use of long life materials.

⑧ Door-open alarm, touch button and large-screen LCD display

⑨ Smooth and effortless drawer slideway



Warning

This appliances is not intended for use by persons (including children) with reduced physical, sensory or mental capabilities, or lack of experience and knowledge, unless they have been given supervision or instruction concerning use of the appliance by a person responsible for their safety. Children should be supervised to ensure that they do not play with the appliance.

Names of parts

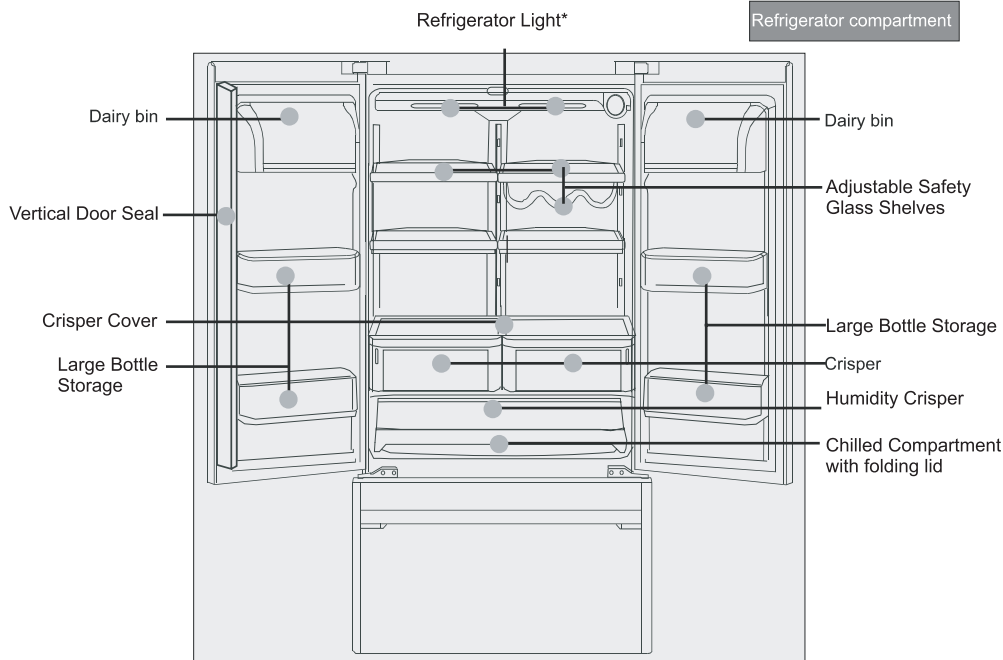

* LED on some models

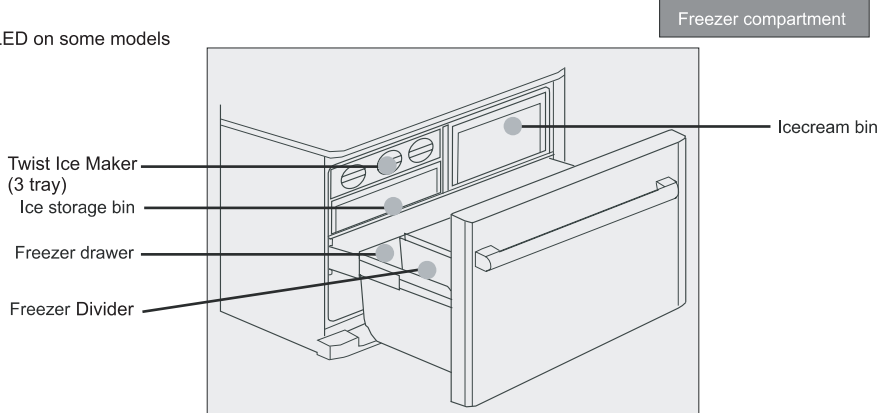

Safety Precautions

Power supply: AC 220V-240V/50HZ

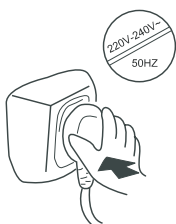

The appliance must be plugged into a dedicated outlet that is securely grounded. The power cord of this appliance is fitted with the three-prong plug (grounded) that complies with the standard three-prong outlet (grounded). Never cut off or remove the third prong. The refrigerator should be located so that the plug is accessible. **WARNING!** The plug should be securely connected to the socket or otherwise fire hazard may arise.

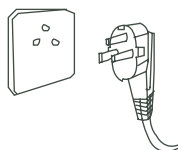

Be careful not to damage the power cord. Always pull at the plug rather than the cord itself to disconnect the appliance from the outlet. Place the power cord in a way to eliminate the risk of damage caused by the weight of refrigerator. Be careful not to damage the power cord when moving the appliance away from the wall.

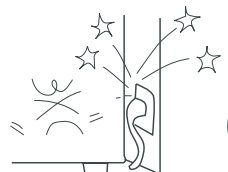

If the supply cord is damaged, it must be replaced by the manufacturer, its service agent or similarly qualified persons in order to avoid a hazard.

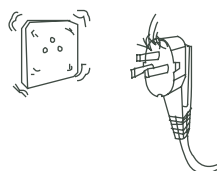

When there is a gas leakage in the house
Shut off the gas valve.
Open the doors and windows for ventilation.
Do not plug or unplug the refrigerator or other electric appliances.



Always remember to unplug the appliance in the following cases:

Unplug the appliance before cleaning and repair.

Unplug the appliance before replacing the old light bulb to prevent electric shock.



Safety Precautions

Never store flammable or explosive items and strong corrosive acids or alkalis in the appliance.
Mousse / Spraying agent / Gas/ Acid / Alkali



This appliance is a household refrigerator, and is intended for food storage only, not for storage of blood, medicine and biological products.



To prevent risk of fire, keep the appliance away from gasoline or any other flammable items.

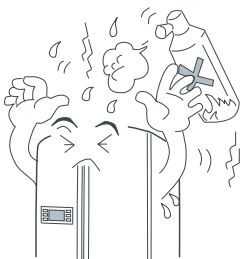

To prevent risk of electromagnetic interference or other accidents, do not place any patch panel, voltage stabilizer and microwave oven on top of the refrigerator or use any electric appliance (unless recommended by the manufacturer) inside the refrigerator.



Children are not allowed to play with the door or the bottle racks. Serious injury may occur. Do not walk on the door or the cabinet when loading and unloading the refrigerator.



The internal surface of freezer compartment is very cold when the appliance is running. Do not touch the surface especially when hands are wet.



Safety Precautions

Hold the door handle when opening and closing the door. The gap between the doors and the cabinet are very small. Make sure fingers do not get stuck. Always keep children away when a door is opened or closed.



Do not splash water onto the refrigerator. Keep away from high humidity environments that can have an adverse effect on the electric insulation performance.



No dismantlement or modification can be made without authorization. Damage to refrigeration system is strictly prohibited. Repair must be carried out by authorized personnel.



Carbonated beverages or pressurised containers should not be stored in the freezer.



Unplug the appliance in the event of power interruption or cleaning. The appliance can be plugged again only after an interval of at least 5 minutes to prevent damage to the compressor caused by frequent startups.

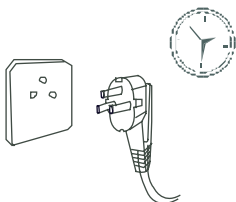

Please remove the door, door seal and shelves before disposal of the old appliance and put them away in a safe place to prevent children from being trapped.

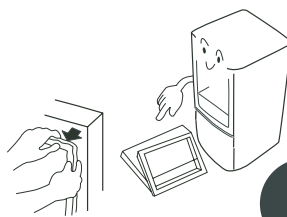

Location

Levelling

The appliance should stand firmly on a solid floor. To support it, use firm and solid pads that are not inflatable. Never use the packaging materials for support. Level the appliance with the adjustable legs whenever necessary. Turn clockwise to raise the refrigerator, and anticlockwise to lower it.

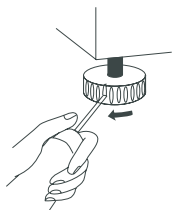

If the heights of the two doors are different, please adjust them according to the below steps:

1. Lift the door which you propose to lift with one hand;
2. Insert the washers with the help of a plier with your other hand;
3. Insert more washers until the two doors are of the same height.

(Three spare washers will be provided together with the refrigerator.)

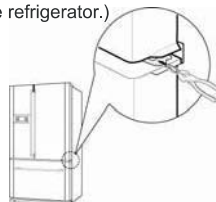

Do not expose the appliance to rain and moisture. Keep the appliance dry and clean.

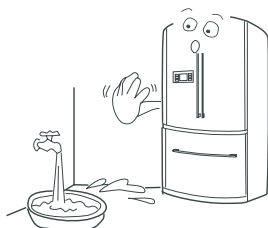

To prevent risk of injury and accident, do not place heavy objects or water containers on top of the refrigerator.



The appliance should be placed in a well ventilated room with 100mm (min) clearance at both sides and at rear surface. If a built-in installation is needed, allow 25cm or more above the top surface of the appliance and 5cm or more away from the wall for proper air circulation.

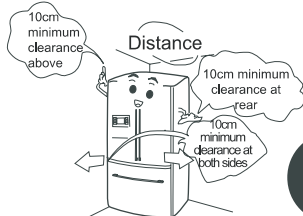

Do not expose the appliance to direct sunlight or heat source.

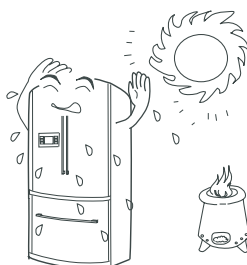

Removing & Replacing Refrigerator Door (RH)



NOTE

To avoid injury, property loss or damage to the refrigerator, make sure to remove all food from door racks and then remove bottle bin(s), unplug the refrigerator and shut off water supply before removing and replacing a door.

To avoid injury or property loss, remove or replace the door with the help of 2 persons or more. The following instructions should be observed.

Removing and replacing the right door of refrigerator compartment

① Unscrew the upper right hinge cover by means of screwdriver and then remove the hinge cover.

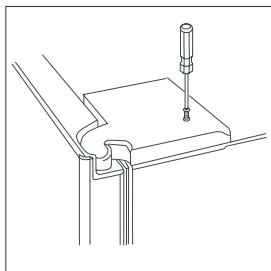

② Unscrew the upper right hinge by means of hexagonal screwdriver and then remove the hinge.

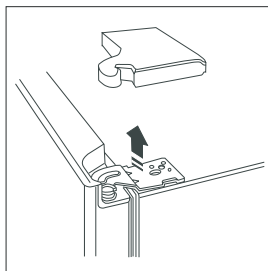

③ Remove the door and place it in a proper position.

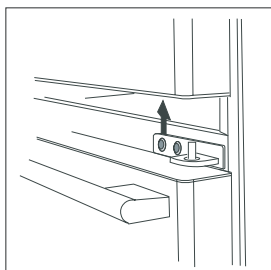

④ Remove the middle hinge if necessary.

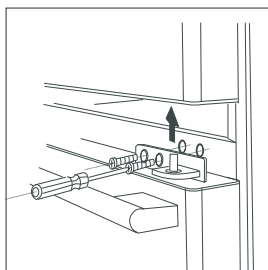

⑤ Replace the door in a reverse sequence of removal.



NOTE

Be careful to prevent the door from falling onto you when lifting the door from the hinge.

Removing & Replacing Door

Removing and replacing the left door of refrigerator compartment

① Unscrew the upper left hinge cover by means of screwdriver and then remove the hinge cover.

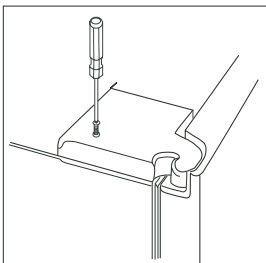

② Unscrew the upper left hinge by means of hexagonal screwdriver and then remove the hinge.

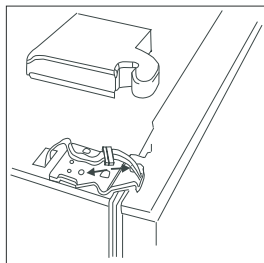

③ Remove the door and place it in a proper position.

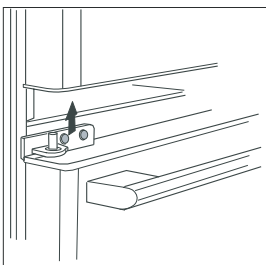

④ Remove the middle hinge if necessary.

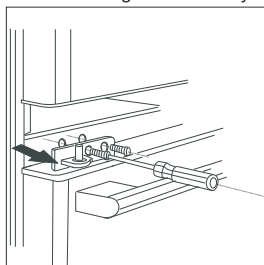

⑤ Replace the door in a reverse sequence of removal.



NOTE

Be careful to prevent the door from falling onto you when lifting the door from the hinge.

Removing & Replacing Freezer Drawer

① Pull out the freezer drawer entirely and remove it from the refrigerator.

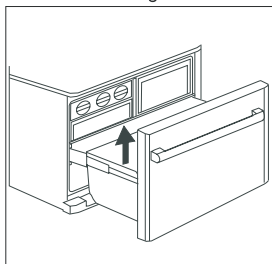

② Replace the freezer drawer in a reversal sequence to removal.



WARNING

To prevent the risk of suffocation, keep children and pets away from the drawers, in case they may get trapped in the drawers.

Preparation

①

Remove all packaging materials.

Foam support and adhesive tapes should be removed.

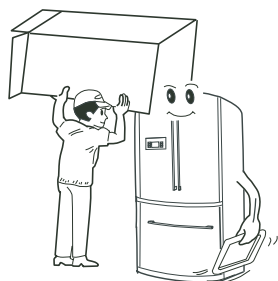

②

Check the accessories and literature.

Check the accessories in accordance with the packing list. Any doubt, contact your Haier Retailer or Customer Care Centre.



③

Locate the appliance in a proper position. See "Location".

Please write down the model number and serial number in Letter of Warranty for later reference.

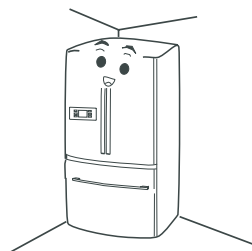

④

It is recommended to clean the appliance before operation.

See "Cleaning".

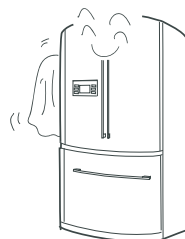

⑤

Standstill

To ensure normal operation, allow the appliance to stand still for 6 hours or longer after installation and cleaning.

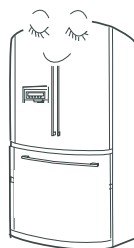

Preparation

⑥

Installing Bottom Trim

Open the door of refrigerator compartment and take out the bottom trim. Fasten it to the bottom of refrigerator with screws as illustrated.



WARNING

Wear a pair of gloves to protect your hands when dismantling the bottom trim and adjustable legs of the refrigerator.

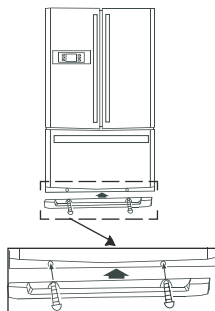

⑦

Installing wine shelf

Open the door of refrigerator compartment. Take out the food shelf at the upper left corner. Place the glass shelf downward on a table. Then take out the wine shelf from the delicatessen drawer at the bottom. Hold the wine shelf at both ends, attach it to the food shelf (as shown below in Fig 1) and then push it in place (as shown below in Fig 3).

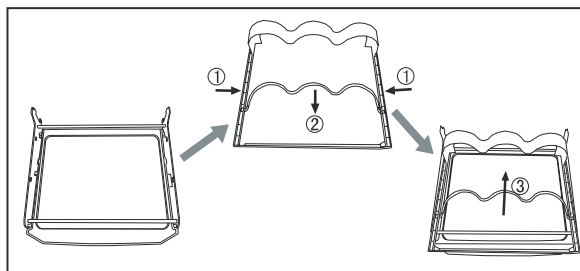

⑧

Installing front cover of chilled compartment

Open the door of refrigerator compartment. Take out the front cover of chill compartment from the crisper cover. Then place the rotary shaft at both ends of the chill compartment into the supporting slot of the slide guide, and turn the front cover of chill compartment down.

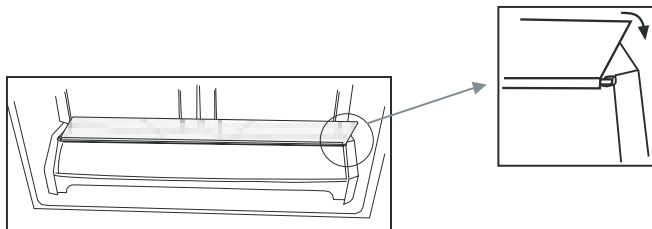

Preparation

⑨ Assembly of the Door Handle

Take out the door handles from the refrigerator compartment (2 longer handles to be installed on the refrigerator and 1 shorter handle to be installed on the freezer). The following instructions should be observed.

Assembly of the Refrigerator Door Handle

Please following the below operations when you are assembling the Refrigerator Door Handle:

- 1)Put the Handle Connector into the right holes on the Refrigerator Door with the help of screwdriver.(as showing by the arrow 1 of illustration 1)
- 2)Put the Refrigerator Door Handle onto the handle holder,and keep the hole of the handle holder and the handle connector to the right position of the vertical direction. (as showing by the arrow 2 of illustration 2)
- 3)Insert the Connecting Bolt of the Handle into the two holes of the Handle Holder with the help of Six angle Screwdriver.(as showing by the arrow 1 of illustration 2)
- 4)Fix the cover of top bolts to the right position. (as showing by the arrow 2 of illustration 2)
- 5)When you are removing the Refrigerator door handle, please follow the instructions in reverse.

Attention:

In case of any special need,please do not disassemble the Refrigerator door handle,In case of any need to change the handle,please get in touch with the technicians

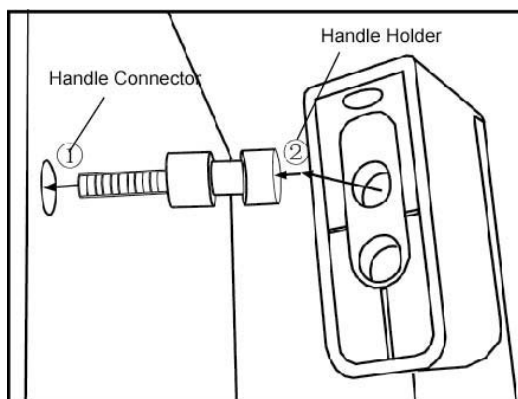

illustration 1

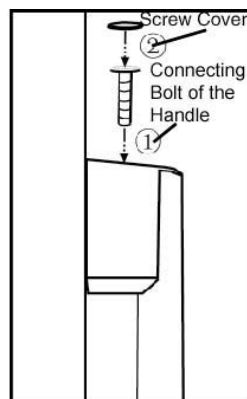

illustration 2

Preparation

Assembly of the Freezer Door Handle

Please following the below operations when you are assembling the Freezer Door Handle:

- 1)Put the Handle Connector into the right holes on the Freezer Door with the help of screwdriver.(as showing by the arrow 1 of illustration 1)
- 2)Put the Freezer Door Handle onto the handle holder,and keep the hole of the handle holder and the handle connector to the right position of the vertical direction.(as showing by the arrow 2 of illustration 2)
- 3)Insert the Connecting Bolt of the Handle into the two holes of the Handle Holder with the help of Six angle Screwdriver.(as showing by the arrow 1 of illustration 2)
- 4)When you are removing the Freezer door handle, please follow the instructions in reverse.

Attention:

In case of any special need,please do not disassemble the Freezer door handle,In case of any need to change the handle,please get in touch with the technicians

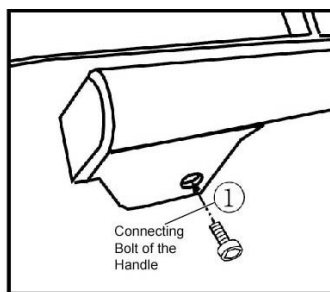
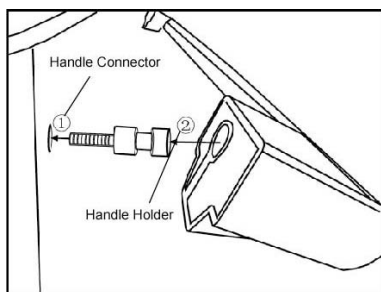

Initial Use

1

1. Connect the appliance to the power supply.

The actual temperatures in the refrigerator and the freezer are shown.
The appliance has a backup memory and the settings before a power interruption will be stored. (See Backup Memory section on Page 15 for details)

2

Operation Modes

Recommendation!

The Intelligent mode allows the appliance to achieve optimal cooling temperatures, regardless of ambient temperature variations.

You can select one of the following operation modes.

- (1) AI: Unless otherwise required, it is recommended that the AI mode is used. Tap the AI button and the indicator will illuminate. The appliance will start an automatic operation. (See the AI Mode section on Page 14)
- (2) Manual: Alternatively, you can adjust the inner temperature by means of the temperature control button. (See the Temperature Setting & Regulation section on Page 15)

3

Loading the refrigerator

The inner compartment will be cold enough and ready for food storage after a couple of hours of non-load operation.



When the temperature setting is adjusted, it takes some time to reach the desired inner temperature. The period will be longer or shorter, depending on the ambient temperature, amount of food and how often the door is opened.

LCD Display And Control Panel

(1) Control panel

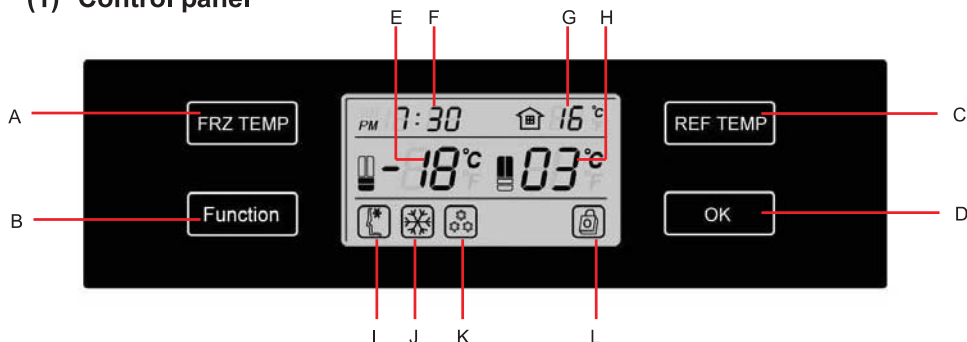

A... Freezer Temperature Adjustment key
 B... Function Selection key
 C... Refrigerator Temperature Adjustment key
 D... Function Confirmation key
 E... Freezer Temperature Indicator
 F... Time Indicator
 G... Ambient Temperature Indicator

H... Refrigerator Temperature Indicator
 I... Artificial Intelligent Indicator
 J... Quick Freezing Indicator
 K... Quick Refrigerating Indicator
 L... Lock Indicator

(2) Artificial intelligence setting

In the artificial intelligence state, the appliance automatically adjusts temperature according to the variation of ambient and compartment temperature without manual adjustment. In the unlocked state, lightly press the Function Selection key (B) several times until the Artificial Intelligent Indicator (I) flashes and then press the Function Confirmation key (D). The Artificial Intelligent Indicator (I) illuminates and the appliance enters the artificial intelligence state. In the artificial intelligence state, lightly press the Function Selection key (B) several times until the Artificial Intelligent Indicator (I) flashes and then press the Function Confirmation key (D). The Artificial Intelligent Indicator (I) goes off and the appliance exits the artificial intelligence state.

(3) Locking/unlocking setting

In the unlocked state, lightly press the Function Selection key (B) several times until the Lock Indicator (L) flashes and then press the Function Confirmation key (D). The Lock Indicator (L) illuminates and the appliance enters the locked state. In the locked state, lightly press the Function Selection key (B) several times until the Lock Indicator (L) flashes and then press the Function Confirmation key (D). The Lock Indicator (L) goes off and the appliance exits the locked state.

In the locked state, adjustment of refrigerator temperature, freezer temperature, artificial intelligent, quick freezing and quick refrigerating are deactivated.

(4) Quick freezing setting

The quick freezing function is designed to keep the food nutrition by making the food completely frozen within the shortest time possible. In the unlocked state, lightly press the Function Selection key (B) several times until the Quick Freezing Indicator (J) flashes and then press the Function Confirmation key (D). The Quick Freezing Indicator (J) illuminates and the appliance enters the quick freezing state. If you want to exit the quick freezing state manually, please lightly press the Function Selection key (B) several times until the Quick Freezing Indicator (J) flashes and then press the Function Confirmation key (D). The Quick Freezing Indicator (J) goes off.

LCD Display And Control Panel

(5) Quick refrigerating setting

The quick refrigerating function is designed to quickly cool the food in the refrigerator to a set temperature. It is best to use this function when a large amount of food has been placed in the refrigerator (such as new groceries) or fresh food. In the unlocked state, lightly press the Function Selection key (B) several times until the Quick Refrigerating Indicator (K) flashes and then press the Function Confirmation key (D). The Quick Refrigerating Indicator (K) illuminates and the appliance enters the quick refrigerating state. The quick refrigerating state will exit automatically when the temperature reaches the setting. If you want to exit the quick refrigerating state manually, please lightly press the Function Selection key (B) several times until the Quick Refrigerating Indicator (K) flashes and then press the Function Confirmation key (D). The Quick Refrigerating Indicator (K) goes off.



If the quick refrigerating or quick freezing function is activated in the artificial intelligent state, the appliance will automatically exit from the artificial intelligent state. Likewise, if the artificial intelligent function is activated in the quick refrigerating or quick freezing state, the appliance will automatically exit from the quick refrigerating or quick freezing state.

(6) Temperature setting and adjustment

Temperature setting and adjustment can be performed as with the following operations only when the appliance is not in the state of artificial intelligent (the Artificial Intelligent Indicator does not illuminate):
Refrigerator temperature adjustment: in the unlocked state, press the Refrigerator Adjustment key (C). The Refrigerator Temperature Indicator (H) flashes. The refrigerator temperature cycles in the sequence of 7°C → 5°C → 3°C → 2°C → 1°C → 7°C each time you press the Refrigerator Adjustment key (C).
Freezer temperature adjustment: in the unlocked state, press the Freezer Adjustment key (A). The Freezer Temperature Indicator (E) flashes. The freezer temperature cycles in the sequence of -16°C → -17°C → -18°C → -20°C → -22°C → -16°C each time you press the Freezer Adjustment key (A).

(7) Door-open warning

If the door is not properly closed or is opened for an extended period, the door alarm buzzer will sound at a certain interval to prompt you to close the door properly.

(8) Energy-saving display

The back-light of the display goes off 30 seconds after a key operation to save electricity and illuminates when any key is operated or any door is opened.

(9) Power-off memory

In the case of power failure, the appliance will save the work state at the moment of power failure and continue to work with the work state after the power is recovered.



Locking function and time are not saved.

(10) Time adjustment and display

In the unlocked state, press and hold down the Refrigerator Adjustment key (C) and Freezer Adjustment key (A) for 3 seconds simultaneously to enter the time adjustment state. The Time Indicator (F) flashes. Press and Freezer Adjustment key (A) to adjust the hour, cycling from 1 to 12. Press and Refrigerator Adjustment key (C) to adjust the minute, cycling from 00 to 59. It will change between AM and PM at the moment of 12:00 (AM means Ante-Meridian and PM means Post-Meridian).

(11) Ambient temperature display

The ambient temperature indicator (G) displays the ambient temperature at which the appliance is currently operating.

About Refrigerator Compartment

- The refrigerator can be used for short-term food storage.

The average temperature of the compartment is generally maintained within 0~10℃ (-2~3℃ for chill compartment). Therefore it is only used for short-term food storage and not suitable for keeping food fresh for a long term.



● Height-adjustable Shelf

The height of the shelf can be adjusted to meet your storage needs.

To adjust the shelf height, remove the shelf first. The steps are as follows: tilt the shelf up at front, and lift it up and out of the tracks. To replace the shelf, with shelf front raised slightly, engage the lugs in tracks. Then lower shelf front until it locks into position.

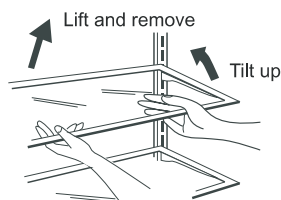

To remove

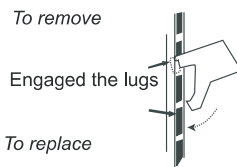

Make sure the shelf is installed securely and in the same level to prevent shelf falling or food spills.

● How to Use the Crisper

The appliance is equipped with a crisper for vegetable and fruit storage. You can set the humidity to meet your storage needs.

- Turn the humidity regulator (located at the upper right corner of the crisper) up to get a higher humidity suitable for storage of cucumber, grape, kiwifruit and persimmon etc.
- Turn the humidity regulator (located at the upper right corner of the crisper) down to get a lower humidity suitable for storage of strawberry, orange, bean, garlic, watermelon, plum and tomato etc.

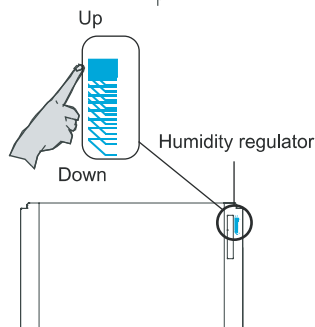

● Removing Crisper Cover

Take out the crisper and put it away. Lift up the cover end (1) and remove it (2).

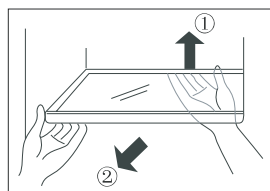

About Refrigerator Compartment

● How to Use the chilled compartment

The appliance is equipped with a delicatessen drawer with a temperature range from -2°C ~ $+3^{\circ}\text{C}$. The temperature can be adjusted by the air control knob to meet your storage needs.

- Turn the air control knob leftwards (weak) to reduce the cooled air moving in the chill compartment and maintain a higher temperature;
- Turn the air control knob rightwards (strong) to increase the cooled air moving in the chill compartment and maintain a lower temperature.

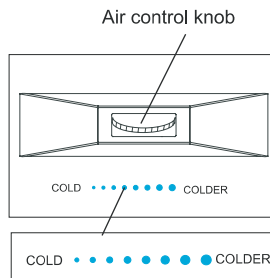

● Cleaning door bins

Lift the bin up (1) and pull it towards you (2). Replace the bin in the reverse sequence of removal after cleaning.

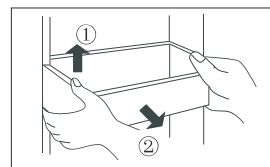

● Food Arrangement

As a result of air circulation in the refrigeration compartment, some areas are warmer and the others are colder. Foods should be organized accordingly.

- ①=Egg, butter and cheese etc.
- ②=Drinks, canned food, condiments etc.
- ③=Beverages and bottled food etc.
- ④=Pickles and canned food etc.
- ⑤=Sausage and snacks etc.
- ⑥=Pastries, canned food, milk and bean curd etc.
- ⑦=Fruit, vegetable and salad etc.
- ⑧=Cold Meats.

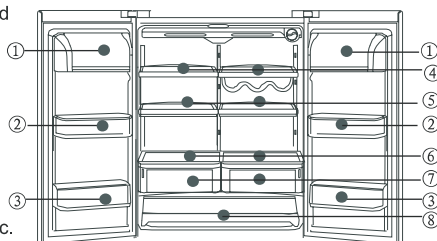

● Replacing the Light Bulb - non LED models

Bulb specifications: 230V~, 25W

Socket: E14 (DO NOT use a bulb over 25W)

- Unplug the appliance.
- ① To remove the light shield, press the stopper at rear out of the square hole.
- ② Pull the shield backward until the retainer is separated from the square hole.
- Turn the bulb anticlockwise and out. Replace a bulb of the same specifications in the reverse sequence of removal.
- To replace the light shield: Engage the retainer into the square hole and then press the shield rear forward until the stopper is locked in the square hole.

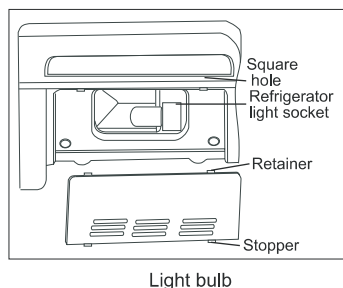

- For LED models ,please see page 28.

Storing Food in Refrigerator Compartment

When loading or unloading the dairy bin, it is safe to open and close the dairy bin in such a way as illustrated below.

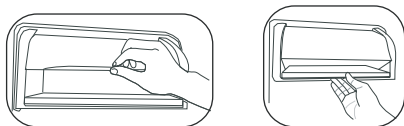

Allow warm foods to cool down before putting them into the refrigerator.

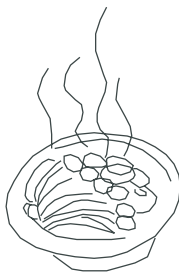

Make sure the food is clean and the extra water is wiped away before storing.



Wrap or cover food before storing.

This will help prevent the loss of water content, keep fruit and vegetable fresh and avoid any unpleasant odor.



Sorting before storage

Sort the foods by category. For those to be used up soon, place them in the front of the shelf, so as to avoid frequent and prolonged door opens and food deterioration.



Do not overfill your refrigerator.

Leave enough space between foods stored in the refrigerator to keep good air-circulation for better refrigeration.

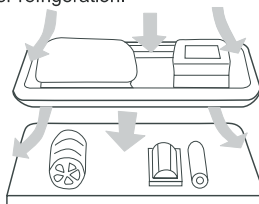

Greasy foods may cause corrosion of lining materials gradually. Keep them away from the walls of inner compartment. Keep the

NOTE inner compartment clean and free of oil stains.

Useful Tips

Remove leaves of carrots and radishes before adding them to the refrigerator, to prevent nutrition loss.

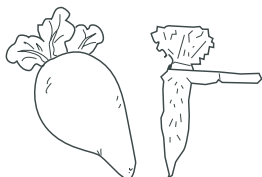

Thaw frozen food in the refrigerator compartment, this will help cooling food in the refrigerator compartment and save energy.



For food which can maintain freshness under ambient temperature storage, such as onions, garlic, and other roots, it is not necessary to put them in the refrigerator.

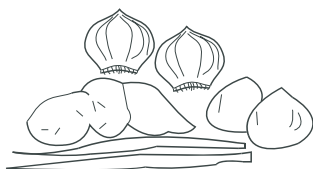

Fruits such as melon, Chinese quince, sweet melon, banana and pineapple can ripen faster under lower temperatures, these fruits are not suitable for refrigerated storage unless you need them to ripen sooner.



About Freezer Compartment

- The Freezer is intended for long-term food storage.

The temperature in the freezer is very low, making it ideal for storage of frozen food. Add food expected to be stored for a longer period of time in the freeze, but the expiry date indicated on its packing should be observed.

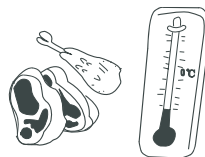

- Adjustable partition wall of freezer drawer

A movable partition wall is provided in the freezer drawer to divide the drawer into two parts. You may move the partition wall right or left to meet your storage needs.

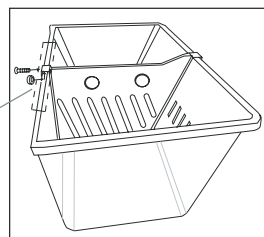
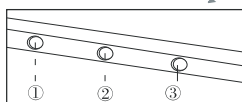

About Freezer Compartment

- If you want to clean the ice-cream box, please follow the steps below:

- 1). Pull out the ice-cream box as far as you can.
- 2). Fold down the clips on both sides of the ice-cream box;
- 3). Take out the ice-cream box and clean it;
- 4). After the cleaning, please install the ice-cream box in the opposite way and fix the clips;

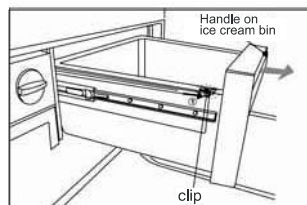

● Icemaking

- Pour water in the icemaker to 3/4 of its capacity and then place it in the freezer.



Fill with potable water

- To get ice cubes, turn the knobs on the icemaker respectively and the ice cubes will be collected in the ice storage bin.
- The ice cubes in the ice storage bin are ready for use.
- When you need more space, the Semi-automatic icemaker can be taken out and Ice storage bin can be used to store more food.

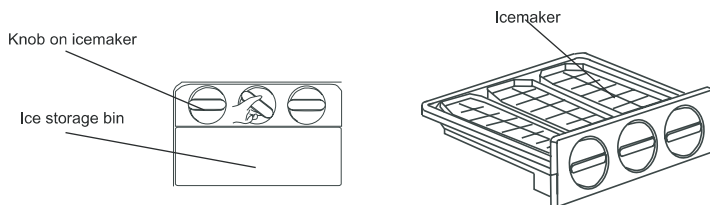
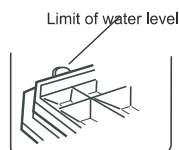

● Replacing the Light Bulb (Non LED models)

Bulb specifications: 230V~, 25W

Socket: E14 (DO NOT use a bulb over 25W)

To replace the light bulb:

- Unplug the appliance.
- ① Remove the front screw with a screwdriver.
- ② To remove the light shield, press the stopper at front out of the square hole.
- ③ Pull the shield forward until the retainer is separated from the square hole.
- Turn the bulb anticlockwise and out. Replace a bulb of the same specifications in the reverse sequence of removal.

To replace the light shield: Engage the retainer into the square hole and then press the shield front backward until the stopper is locked in the square hole. Replace and tighten the screw.

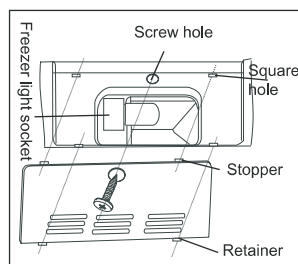

Freezer light bulb

Storing Food in Freezer Compartment

Allow warm foods to cool down before putting them into the freezer.



Store food in smaller packages. This will make it easier to freeze the food fully and provide better quality when the food is thawed. It's recommended that each package should not exceed 2.5kg.

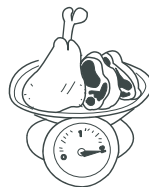

Wrap food before storing. Make sure the wrappings are dry to prevent them from sticking to each other. The wrapping materials used should be odorless, airtight, leak-proof, nontoxic and environmental friendly to prevent unpleasant odor or food deterioration.

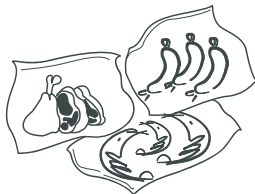

The package of food should indicate information such as name of food, date of storage and expiry date.

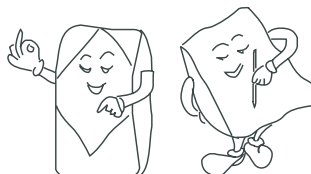

Once thawed, food cannot be returned to the freezer unless it has been cooked. Always get frozen food from the freezer for thawing according to actual needs.



Do not put too much fresh food in your freezer. The freezing capacity (as indicated in the Technical Data sheet) should be observed.

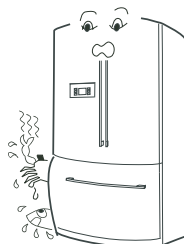

Cleaning

Defrosting Freezer Compartment

The defrost cycle of the freezer compartment is automatic and no manual operation is needed.

Cleaning

Clean the inner compartments to get rid of food residues and eliminate unpleasant odors.

- Unplug the appliance before cleaning.
- Use a cloth or sponge to wash the inner compartments with lukewarm water and mild detergent.
- Dry the external surface with a dry cloth.

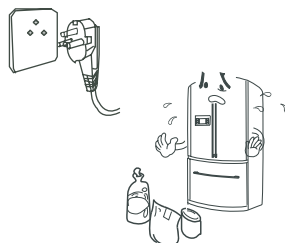

NOTE

- ① The appliance is heavy. Protect the finish of flooring if the appliance has to be moved during cleaning and servicing.
- ② Do not splash water on the appliance.
- ③ To clean electric components such as switches and illuminators, make sure the appliance is not connected before cleaning with a dry cloth.
- ④ When cleaning, do not use sharp or pointed brush, hard cleansers, gasoline, amyl acetate, acetone or other organic solvents, boiled water, acid or alkali.
- ⑤ Do not touch the cold metal surface when the hands are wet.
- ⑥ When cleaning, do not use hot water to clean the glass shelves. Glass may get broken due to thermal shock and cause the risk of injury and property loss.
- ⑦ Clean the door seal from time to time.
- ⑧ Never use amyl acetate to get rid of any unpleasant odor. This chemical may cause a fire hazard.
- ⑨ Mild, non-caustic detergents should be used in cleaning.

Vacation

Power failure

Food can be stored well for several hours in the event of power failure even if it is in summer.

- Do not add foods to the appliance and keep the doors closed for as long as possible during power failure.
- If a power failure is announced beforehand, make some extra ice cubes and hold them in a leak-proof container. Place the container on the top shelf in the refrigerator compartment.

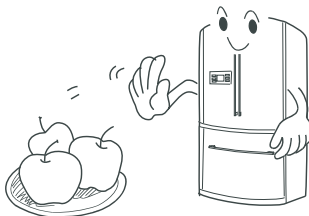

NOTE

Temperature rise in the freezer due to power interruption or other faults may shorten the shelf life and have an adverse effect on food quality.

Stop Using

Please unplug the appliance and clean it as described above if the appliance will not be used for a long period of time.

Keep the door open to prevent unpleasant odors caused by food residues.

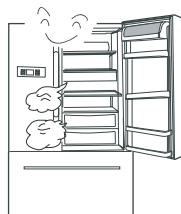

NOTE

To ensure a long service life, do not stop the appliance frequently.



NOTE

After unplugging the appliance, wait 5 minutes at least before connecting it to the power supply again.

Vacation

When leaving for a vacation

- If you are leaving for a long vacation, and it's necessary to shut off the power, take out all of the foods, defrost and clean the appliance. Dry the appliance and leave the door open to prevent odors



WARNING

A discarded appliance must be disposed by professional personnel, or otherwise may have an undesired impact on the environment or give rise to other hazards.

When moving your refrigerator

- Unplug the appliance before transportation.
- Take out foods from the appliance.
- Fix the shelves in refrigerator, crisper and shelves in freezer in position with adhesive tapes.
- Keep the door closed during transportation with adhesive tapes.
- When moving the refrigerator, it cannot be tilted over 45 degrees (the angle to the vertical direction). Otherwise it may cause the risk of malfunction of the refrigeration system.

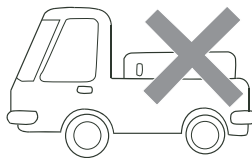
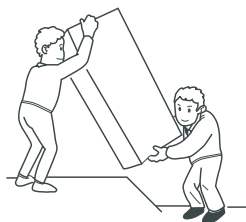

NOTE

Keep the refrigerator upright .

Troubleshooting Tips

It's normal that when the refrigerator is first plugged in, the compressor operates for long periods or cycles on and off frequently. It would take a longer time for the inner temperature to reach the desired value.

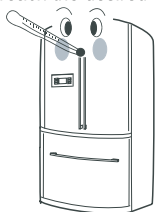

It's normal that the refrigerator is humming when first plugged in or started up. The sound will fade away when the refrigerator is in stable operation.

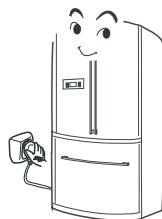

It's normal that the external surface of refrigerator gets warm, especially when first plugged in, as a result of anti-sweat design.

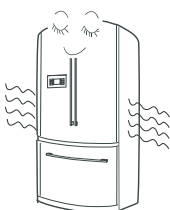

The compressor may cause a humming sound during operation and a clicking sound upon starts and stops.

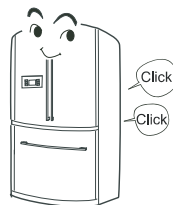

The flow of refrigerant through the refrigeration coils may make a babbling noise. The noise is usually found at the evaporator and the compressor. When the compressor comes to a stop, the backflow of refrigerant will make a noise like running water from time to time or continuously.

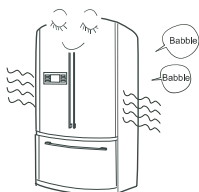

Water dropping on the defrost heater can cause a sizzling or buzzing sound during a defrost cycle. At the end of a defrost cycle, a slight popping sound may be heard, and the evaporator may make a gurgling noise like boiling noise.



Troubleshooting Tips

It's normal that there is a noise of fan spinning during operation.

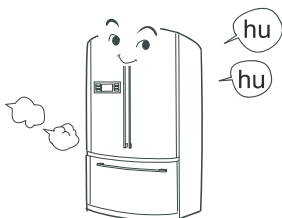

Expansion and contraction of the evaporator and refrigerating coils due to temperature change can cause a cracking or popping sound.

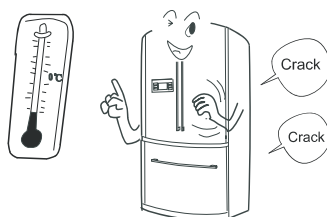

Moisture may form on the outside of refrigerator and between the doors during periods of high humidity.

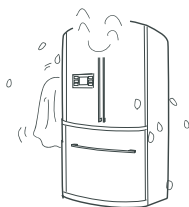

The rated power consumption specified in the Technical Data sheet is measured during a period of 24 hours under stable operation at an ambient temperature of 25°C with the refrigerator and freezer maintained at 5°C and -18°C respectively. The actual power consumption depends on the amount of fresh food stored in the refrigerator,

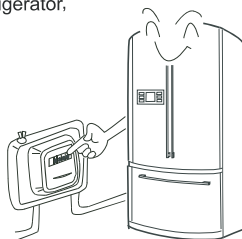

After-sale Service

When calling for service, provide the model number, list of accessories and the serial number (described in the nameplate of the product).



Before calling for service, check the following points to see if you can solve the problems yourself.

Refrigerator does not work.



Refrigerator is not connected to the power supply (plug, outlet and fuse) or the power control is set to OFF.



Voltage is too low.

After-sale Service

Interior light does not work.



Light bulb has burned out.



Refrigerator is not connected to the power supply.

Unusual noise

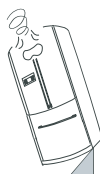

Refrigerator is not level.



Refrigerator rubs against the wall or furniture.

Compartments are warmer than expected



Door is not closed properly, opened frequently or kept open too long.



Temperature is set a warmer setting. (see the Functions section from page 14 to page 15.)



The appliance is exposed to direct sunshine or placed near a stove or radiator.



Poor ventilation. Check if the heat radiation unit on the rear is blocked.

Before calling for service, check the following points to see if you can solve the problems yourself.

Compressor operates for long periods or cycles on and off frequently.

- It's normal when refrigerator is first plugged in.
- A large amount of food is placed in the refrigerator for storage or freezing.
- Door is left open or held open by food package.
- Door is opened frequently.
- It is hot weather.
- Temperature is set a warmer setting. See the Initial Use section.
- Poor ventilation

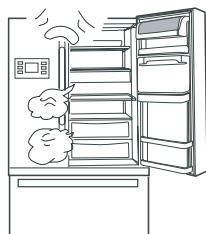

Frost or ice crystals form on food.

- Frost within package is normal.
- Door is left open or held open by food package.
- Door is opened frequently or kept open too long.
- Food is placed near the vent.

Unpleasant odor

- Food with strong odors should be tightly wrapped.
- Food is deteriorated.
- Compartments need cleaning.



Replacing the Refrigerator/Freezer Bulb

About Refrigerator Compartment(HTD647RSS)

● Replacing the Light Bulb

Bulb specifications: DC12V 1W
(DO NOT use a bulb over 1 W)

To replace the light bulb:

- Unplug the appliance.
- ① Remove the front screw with a screwdriver.
- ② To remove the light shield, press the stopper at front out of the square hole.
- ③ Pull the shield forward until the retainer is separated from the square hole.
- To replace the light shield: Engaged the retainer into the square hole and then press the shield front backward until the stopper is locked in the square hole. Replace and tighten the screw.

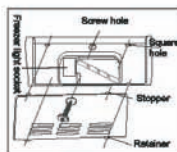

Freezer light bulb

• Changing the Fresh Food Light Bulbs

The voltage and wattage of the fresh food bulbs are: DC 12V 1W
(Never use bulbs with power over 1 W)

When changing the light bulbs:

- Pull out the power cord plug from the wall outlet, cutting off the power.
 1. Use your hands to press down at the back of the light-shield releasing two tabs.
 2. Then hold the light-shield and pull it out, as shown in the right picture.
- Turn the bulb in a counter-clockwise direction, then install a new bulb in the reverse order.
- Install the light-shield back in the tabs in the reverse order, and snap back in place.
- Air curtain removing and installing (only for servicing if needed)
 1. Remove the water filter
 2. Take off the fresh food light-shield, and unscrew the bulb.
 3. Remove the screws of the air curtain frame, using the screwdriver.
 4. Take down the fresh food aircurtain using your hands to press down on the air curtain a little hard.
- Installing the air curtain can be done in the reverse order.

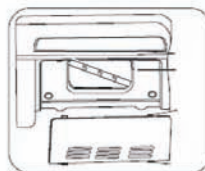

About Freezer Compartment (HTD647RSS)

● Replacing the Light Bulb

Bulb specifications: DC 12V 1W

(DO NOT use a bulb over 1 W)

- Unplug the appliance.
- ① To remove the light shield, press the stopper at rear out of the square hole.
- ② Pull the shield backward until the retainer is separated from the square hole.
- To replace the light shield: Engaged the retainer into the square hole and then press the shield rear forward until the stopper is locked in the square hole.

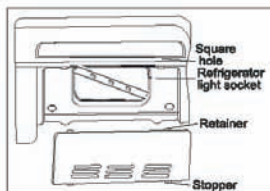

Light bulb

The electrical rating of the bulb is:
DC12V 1W

The lampholder is type LED. (Never use bulbs with power over 1 W). While changing the light bulb :

- Pull out the power cord plug to cut off the power.
- Lift the light-shield slightly in the direction upward, then pull it out in the direction shown.
- Install the light-shield in the reverse order.

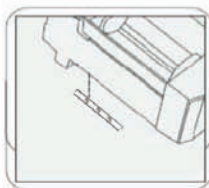



Technical Data • Circuit Diagram • Packing List

Packing List

Name	Washer	3
	Front cover of chill compartment	1
	Handle fastener	6
	Bottle Racks	4
	Dairy bin	2
	Crisper	2
	Crisper cover	1
	Chilled Compartment	1
	Refrigerator shelf	2
	Movable shelf	2
	Wine shelf	1
	Twist Ice Maker	1
	Ice storage bin	1
	Freezer drawer	1
	Freezer divider	2
	Ice cream bin	1
	Handle	3
	Bottom trim	1
	Leg	2
	User Manual	1
Quantity		

The product specifications are subject to change from time to time due to product improvement without further notice.